

## ADDITIONAL MATERIALS TO THE ARTICLE

# **A Bourdieusian Framework for Understanding Transformations of Public Space Heritage: Case of Castle Square in Riga**

Helena Gutmane

helena@alps.archi

Department of Architecture, KU Leuven, Belgium;

Faculty of Geography and Earth Sciences, Latvian University, Latvia.

# Content

List of used abbreviations 3

Links and references not included in the final version of the article 4

Caste Square

*Existing situation* 5-10

*Historical materials* 11-20

*Schemes, sections, visualisations: materials from winning proposal* 21- 30

*Materials intermediate proposals* 31 -32

*Materials final proposal* 33-35

*Participation events during the elaboration of the project* 36-39

## List of used abbreviations

CPT	communicative planning theory
RPM	rational planning model
RHC PZ	Riga historical centre and its protection zone
RVC SAP	Commission for Preservation and Development of Riga historical centre
RTP	Riga territorial plan
URBACT	the European Territorial Cooperation programme aiming to foster sustainable integrated urban development in cities across Europe. <a href="https://urbact.eu/who-we-are">https://urbact.eu/who-we-are</a>

# Links and references not included in the final version of the article

Blūzma, V. (2020, December). Unification vs. local autonomy: evolution of law in baltic provinces under rule of the great powers in 16th–19th century. In *Proceedings of the International Scientific Conference "Social Changes in the Global World"* (Vol. 1, No. 7, pp. 17-40).

Cita Rīga, <https://www.citariga.lv/lat/vecriga/laukumi/pils-laukums/>

<https://www.europeana.eu/de/item/92085/4298>

Gabre, A. (2006, June 28) Rīgas apstādījumu koncepcija ir tapusi. The concept of greenery in Riga has been created. Rīgas balss. <https://www.tvnet.lv/4993551/rigas-apstadijumu-koncepcija-ir-tapusi>

Gabre, A. (2010, 30 October) Vairākums rīdzinieku ir pret koku ciršanu Pils laukumā. The majority of Riga residents are against cutting down trees on the Riga Castle Square.

Gehl, J. (2001). Pētījums par Rīgas centra pilsētvidi un publisko telpu (Public Spaces & Public Life in Riga City Centre)

Info, (2009)

<https://info.iub.gov.lv/lv/meklet/pc/RD%20PAD%202009%7B%7C%7D14/cc/LV90000056484/pbl/1/>

Letonika <https://www.letonika.lv/groups/default.aspx?g=3&r=11012&q=R%C4%ABgas%20pils>

NRA <https://nra.lv/latvija/riga/34308-vairakums-ridzinieku-ir-pret-koku-cirsanu-pils-laukuma.htm>

Rīgas meži [https://www.rigasmezi.lv/lv/Rigas\\_darzi\\_un\\_parki/vesture/Rigas-darzu-un-parku-vesturisks-raksturojums/](https://www.rigasmezi.lv/lv/Rigas_darzi_un_parki/vesture/Rigas-darzu-un-parku-vesturisks-raksturojums/)

RPADa. (2013) <https://www.rdpad.lv/projekta-atbalsta-grupas-pamatsastava-sanaksme-notika-2013-gada-7-junija-rigas-domes-pilsetas-attistibas-departamenta/>

RPADb. <https://www.rdpad.lv/user-seminars-riga-drosa-publiska-artelpa/>

SUS <https://sus.lv/index.php/petijumi/petijums-par-rigas-centra-pilsetvidi-un-publisko-telpu-public-spaces-public-life-riga-city>

TOP VIDE. (2004). Dabas pamatnes precizēšana Rīgas pilsētas teritorijas plānojumam (Clarification of the natural basis for the planning of the territory of the city of Riga).

<https://sus.lv/index.php/petijumi/petijums-par-rigas-centra-pilsetvidi-un-publisko-telpu-public-spaces-public-life-riga-city>

<https://zudusilatvija.lv/lv/objects/search/cee23f487cc8b059c53eaa5a40b7fa8d/>

Zvirgzdiņš, A. (2021 October). Okupācijas laukumu sagaidot. (Waiting for Occupation square). <https://a4d.lv/raksti/okupacijas-laukumu-sagaidot/>

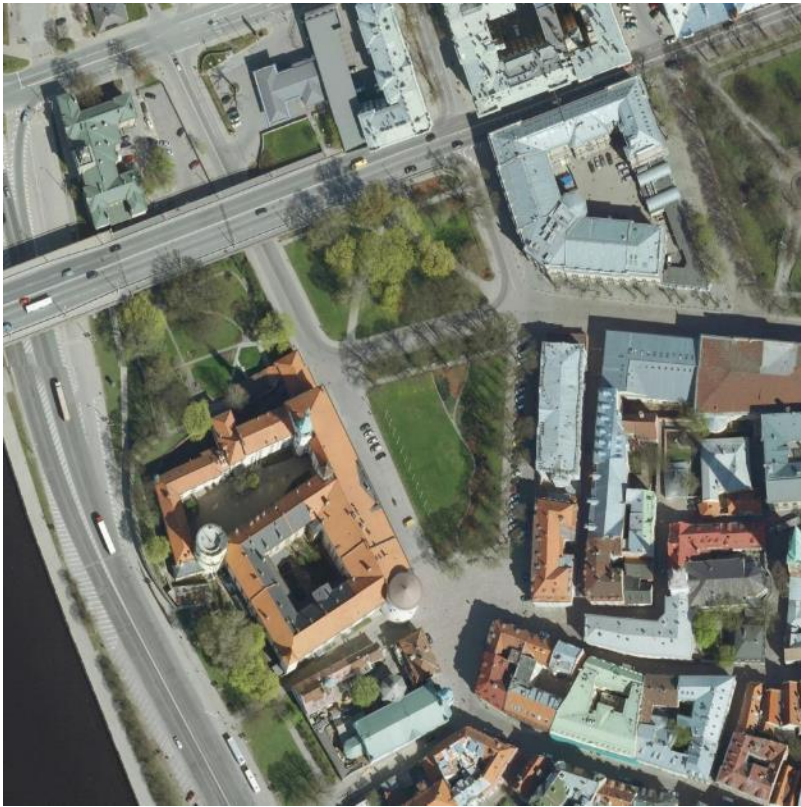





<https://www.la.lv/pirms-vansu-tilta-veidojas-lieli-sastregumi-uz-salu-tilta-lena-satiksme>



<https://nra.lv/latvija/riga/207029-agrak-neka-ierasts-riga-veidojas-sastregumi.htm>











# letvju seguma veidi

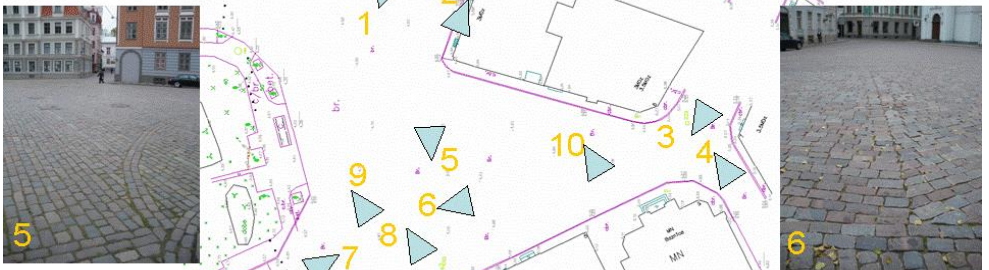



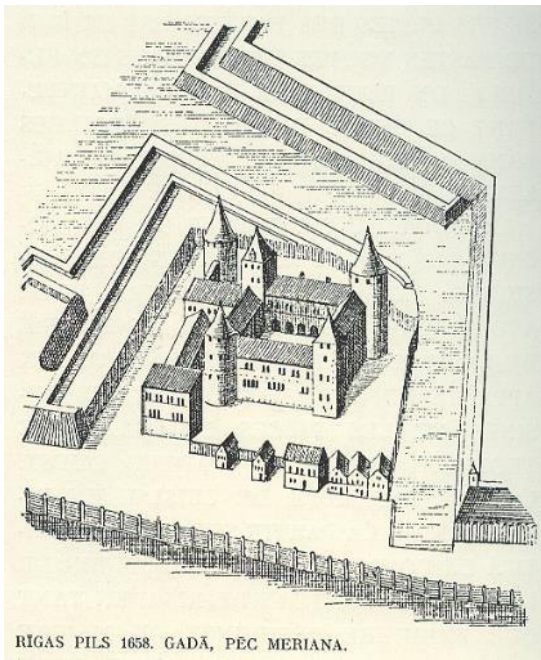

RĪGAS PILS 1658. GADĀ, PĒC MERIANA.

ca.1895

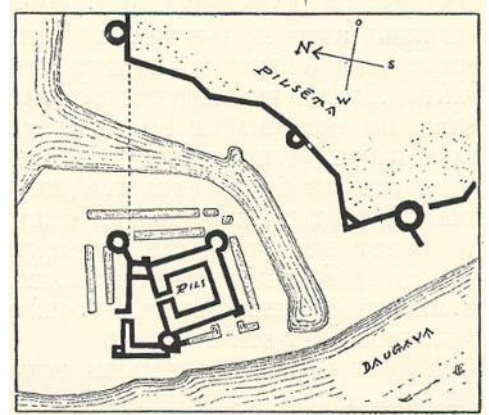

RĪGAS PILS NOVIETNE 1646. G., PĒC ZVIEDRU UZMERLUMA.

ca.1895

ca.1895





Johann Christoph Brotze, beginning of 19th century





19th century



ca.1895

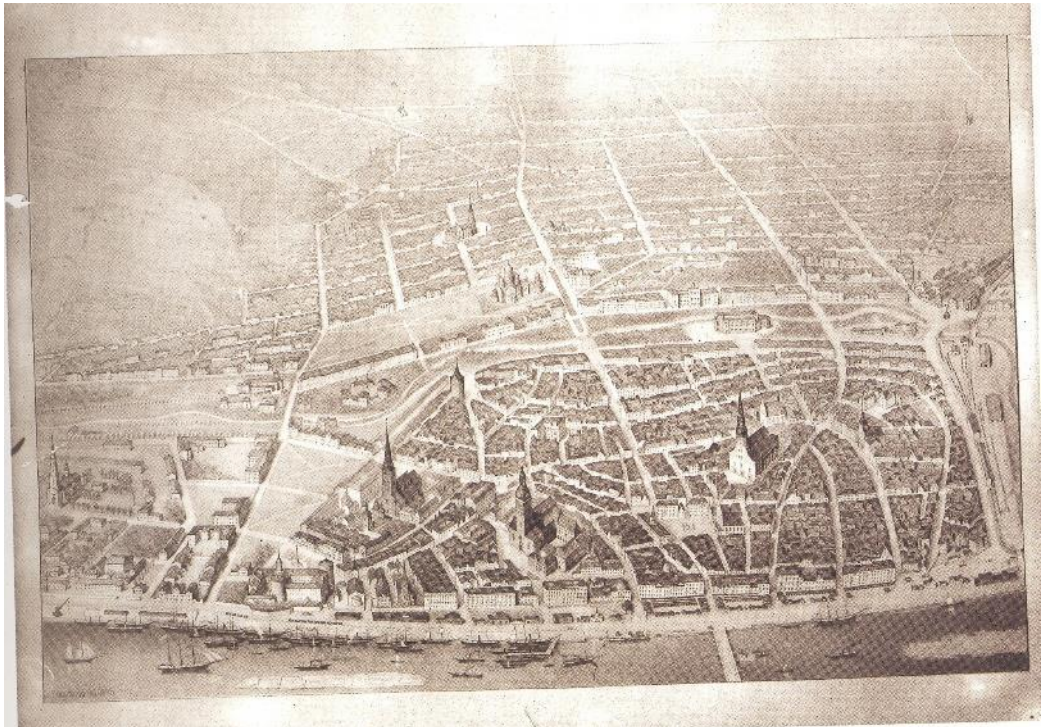

**ГОСТИНИЦА С. ПЕТЕРБУРГЪ въ РИГѢ,**

напротивъ Запка и вѣходной набережной, сѣвъ реконструирована въ высш. цѣловѣстническомъ стилѣ и удобнѣе по внутреннему расположенію. Хозяинъ обладаетъ услугами исправнѣе образованн. и до укрѣпленія ясны. Занятия Европейскихъ профессоровъ въ хорошихъ классахъ по въ классическ.

opposite the Castle and landing place of the Steamships is built in the most improved style of the Masters. Being set in elegant and comfortable, the rooms are furnished and Travellers will be attended to with propriety. Staff & large Coach houses.

**HOTEL DE ST. PETERSBURG à RIGA**

sur le vis à vis du Château et de l'arriv. des bateaux à vapeur est reconstruite aux Vaugouars. L'élegance et la commodité de cet Etablissement ne laissent rien à désirer. Prix modérés. Supplémentaires Remises pour des voitures.

**Hôtel St. Petersburg in Riga.**

dem Kaiserlichen Schlosse u. dem Landungsplatze der Dampfschiffe gegenüber, empfielt sich durch elegante u. bequeme Einrichtung den resp. Reisenden u. verspricht bei rechtler u. prompter Besorgung die billigsten Preise. Für sichere u. bequeme Unterbringung der Equipagen ist gesorgt.

End of  
19th  
century

Around  
1850







Ca. 1817





Riga

Das Schloss

Latvianika.lv - atbildes, kuras tu meklā

▲ Around 1850

Beginning 20th century, after 1904 ▼



Рига - Замковая площадь.

RIGA - Der Schlossplatz.





Between 1910 and 1930

Andrejs Zeidaks 1923-1928





Ervīns Volfeils 1926

Beginning 20th century



Lefonka.lv - atbildes, kuras tu meklē





Letonika.lv - atbildes, kuras tu meklē

End of 19th century

Ca. Between 1930 and 1940



Rīga. Pils.

Letonika.lv - atbildes, kuras tu meklē

№ 645



Riga

Schloss

No. 95.

▲ Around 1860 ▼

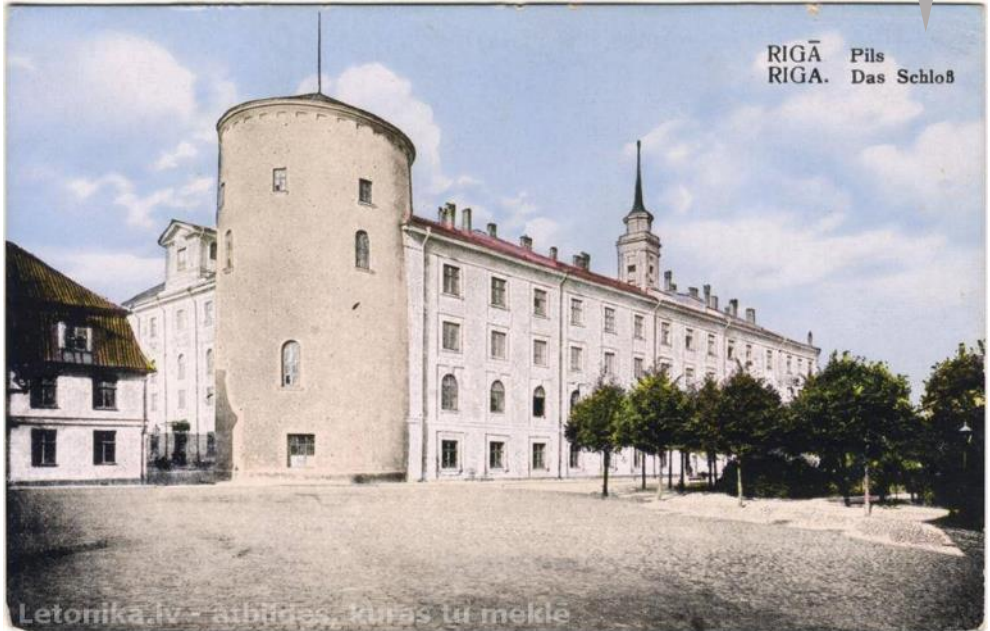

RIGĀ Pils  
RIGA. Das Schloß

Letonika.lv - atbildes, kurās tu meklē



Fragment of the initiation letter of the President of Latvia

27/05 2008 09:54 FAX 7026184

RD-KANCELEJA

001/002

*J. Francim  
A. Ciniņ  
Paciņai  
(informēt mani!)*

*1-24 1  
17.04.08*



**Pievienot pie saņemtiā faksa dokumenta**

Rīgas domes  
Pilsētas arhitektūras departamenta  
direktora p.l.

*Latvijas Valsts prezidents*

Nr. 431

**G. PRINCIS**

17-04-2008

2008. gada 17. aprīlī

*G. Kukuļska Krišm  
L. uzdevēt nepieciešam  
darbības  
Rīgas domes  
Pilsētas arhitektūras departamenta*

**A. god. Jānim Birkam  
Rīgas Domes priekšsēdētājam**

# Mobility existing

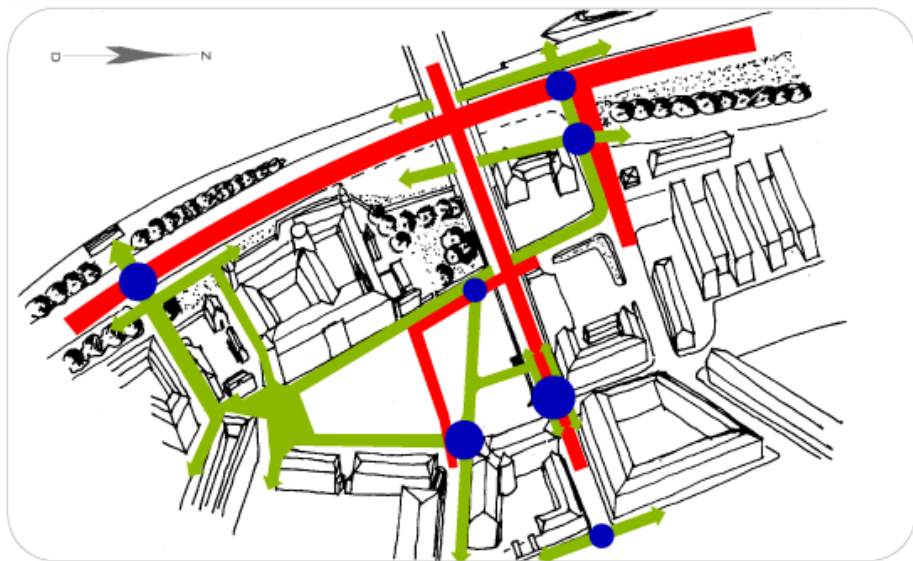
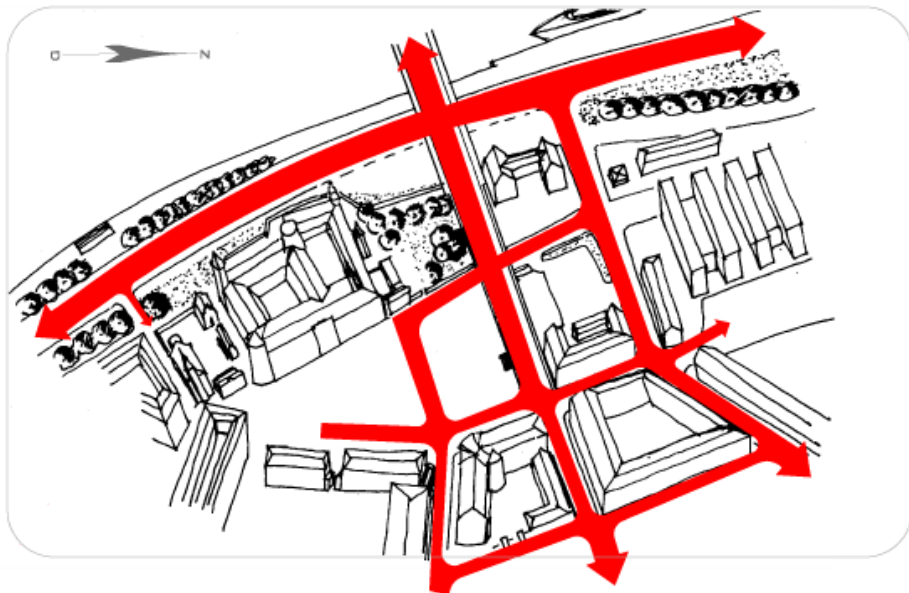

# Mobility proposed

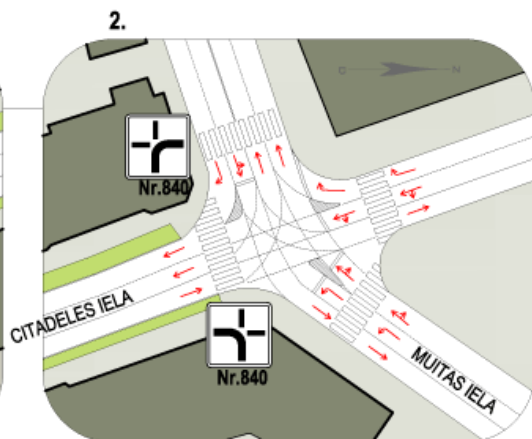
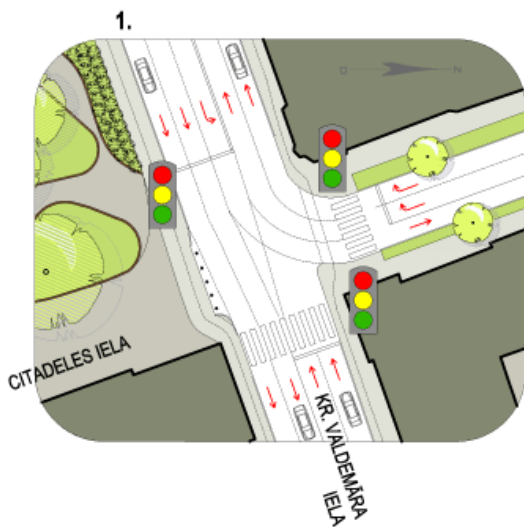
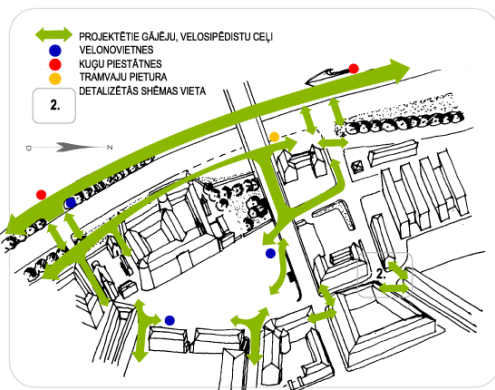
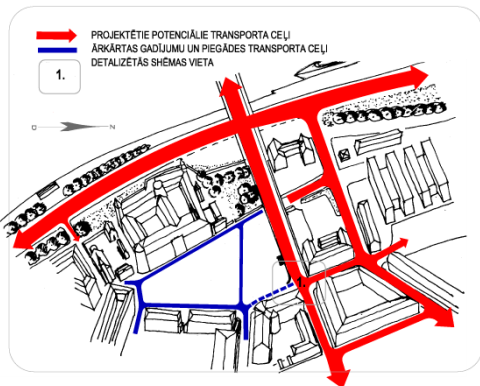





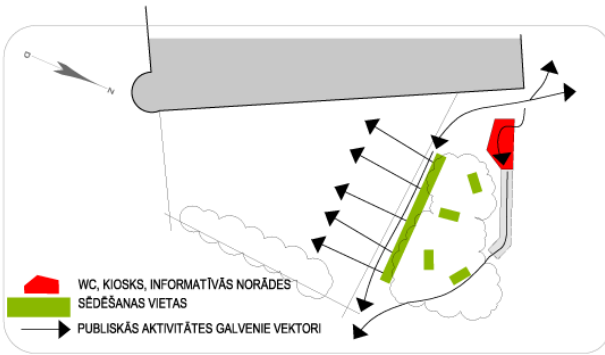
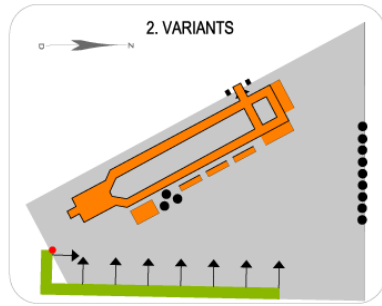
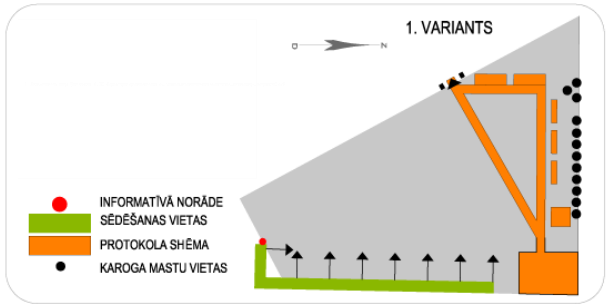

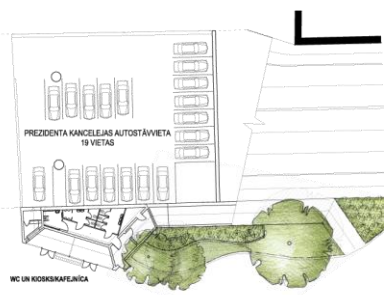
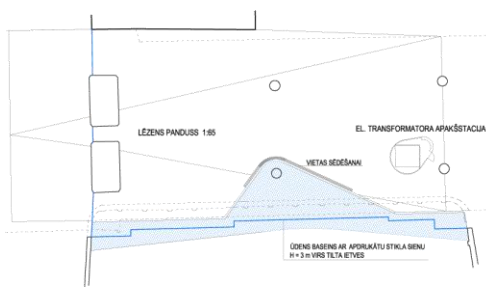
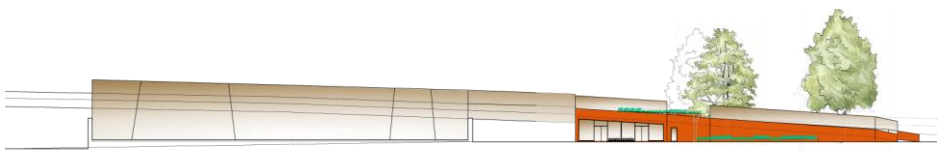
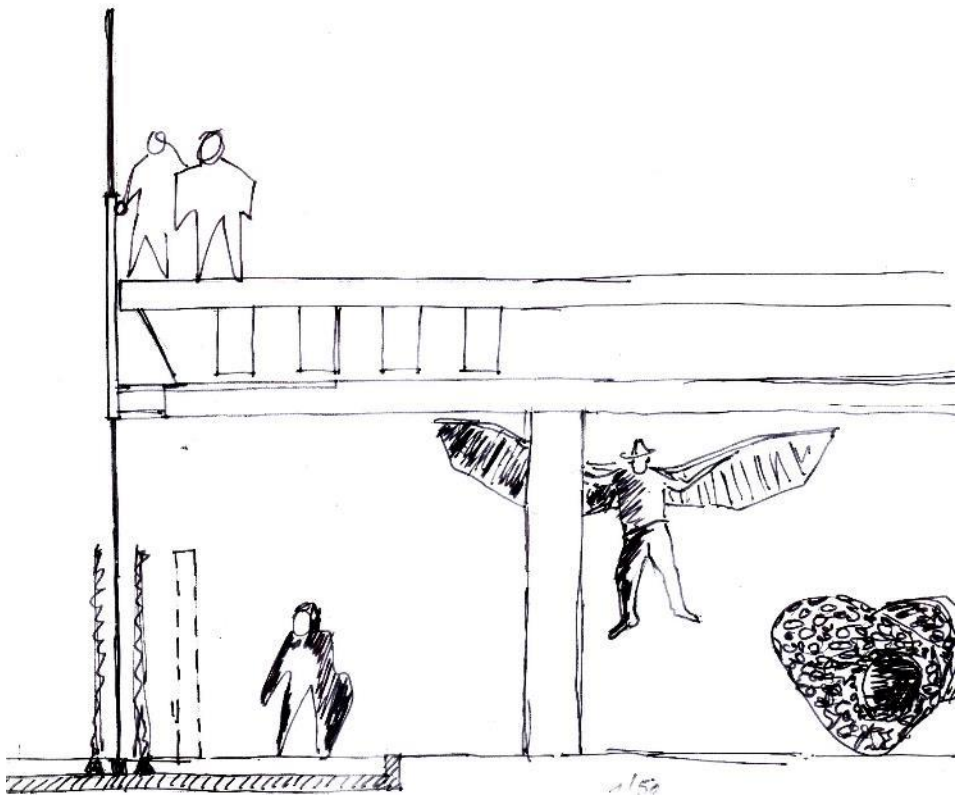



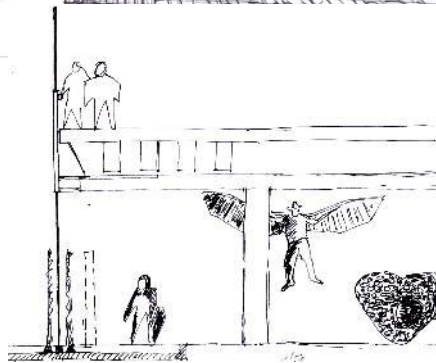









# INTERMEDIATE VERSIONS









FINAL VERSION

31.08.2010 RVC SAP

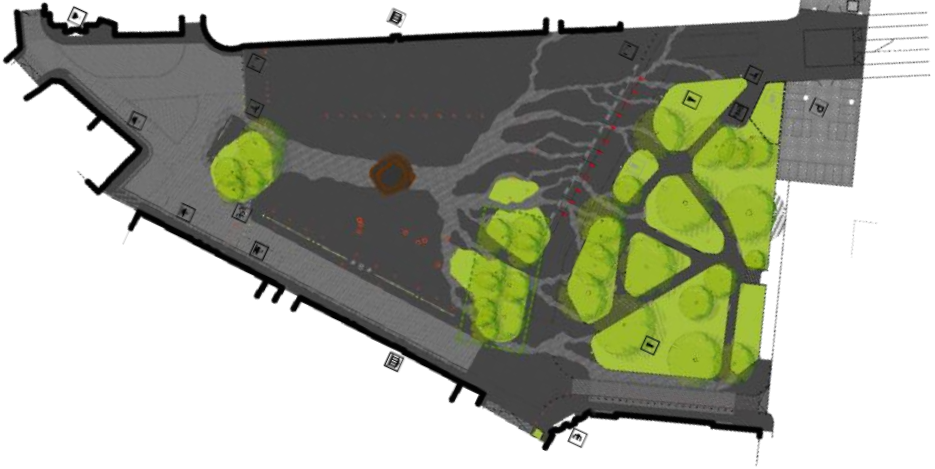

2011. gada (pēc koku ciršanas publiskās  
apspriešanas) apstiprinātais

